

2 FOUNDATION PLAN
SCALE: 1/8"=1'-0"

- NOTES:
1. CONCRETE TO MEET CAN/CSA-A23.1, COMPRESSIVE STRENGTH OF 25 MPa AT 28 DAYS. 1/2" AGGREGATE, 58% AIR ENTRAINMENT, SLUMP 3-4".
 2. REINFORCING STEEL TO BE DEFORMED BILLET BARS TO CSA G40.21 GRADE 300.
 3. CONCRETE WORK UNDERTAKEN WHEN TEMPERATURE IS BELOW 5° C TO BE PLACED IN ACCORDANCE WITH CAN/CSA A23.1 "COLD WEATHER CONCRETING".
 4. CONCRETE SLAB & BUILDING TO BE CONSTRUCTED AT CARTWRIGHT, MANITOBA.
 5. FOUNDATION DESIGNED AS A "FROST-PROTECTED" FLOATING SLAB BUILDING DESIGNED FOR AVERAGE LOADINGS OF 2.4 KPA. PERMETER THICKENED EDGE TO SUPPORT PERMETER LOADS OF 24 KPA BASED UPON SNOW LOADINGS OF 2.1 KPA (1.35).
 6. NOTE: OWNER DESCRIBES SOIL CONDITIONS AS GOOD, WELL DRAINED CLAY SOIL WITH SOME GRAVEL VENS. ALLOWABLE BEARING CAPACITY EXCEEDING 60 KPA.

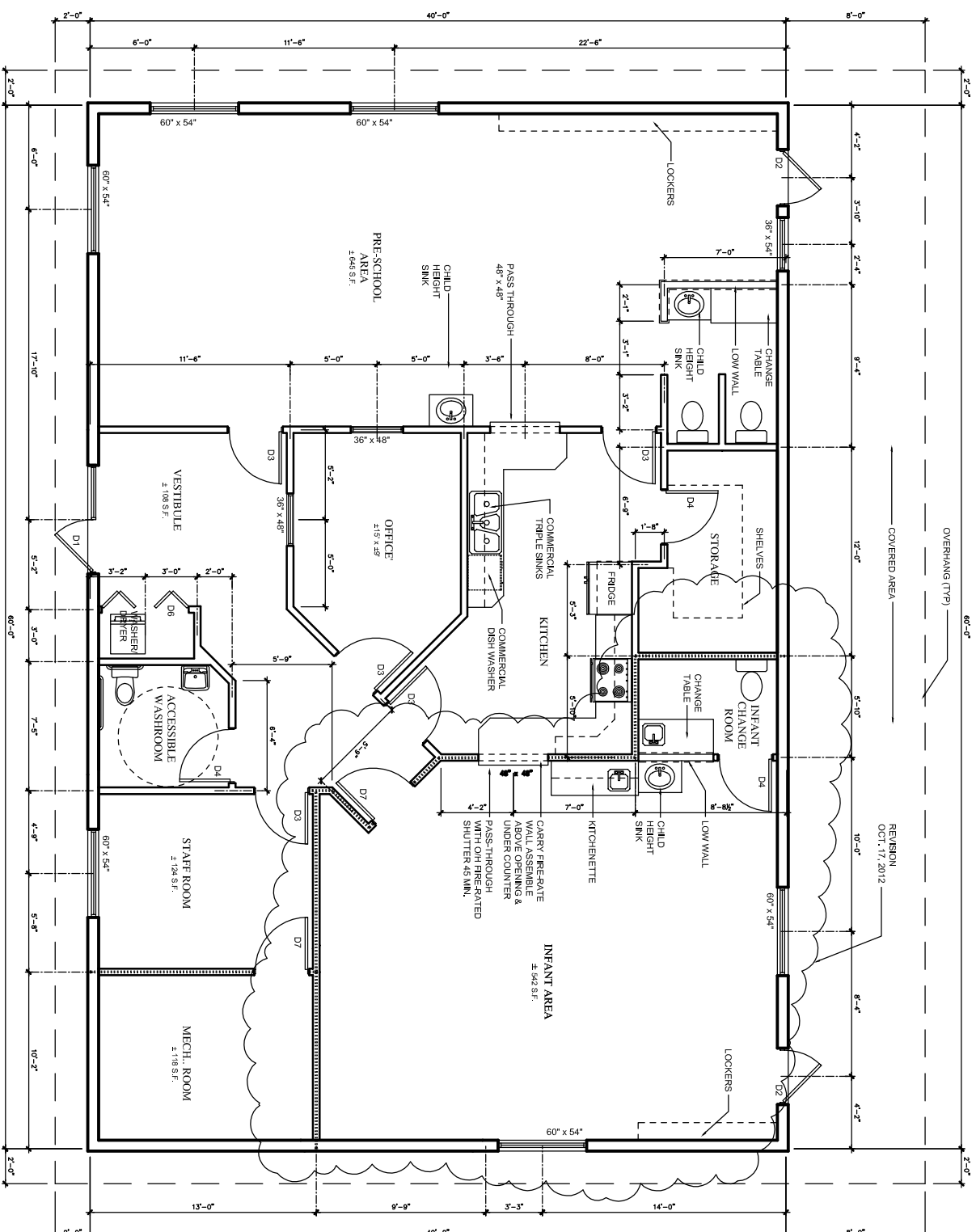

1 FLOOR PLAN
SCALE: 1/8"=1'-0"

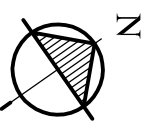

1 HOUR FRESH-AIR WALL
1/2" TYPE "X" GYPSUM BOARD
3/4" WOOD STUD FRAMING
1/2" TYPE "X" GYPSUM BOARD

DR. STYLE	WIDTH	HEIGHT	THICKNESS	TYPE	FINISH	PROTECT.	FIRE RATING	NOTES
D1	6'-0"	6'-8"	1 1/2"	H.M.L.	P.AINT	K.P.	-	DOOR C/W FULL GLASS & FIXED SINGLITE
D2	3'-0"	6'-8"	1 1/2"	H.M.L.	P.AINT	K.P.	-	DOOR C/W FULL GLASS
D3	3'-0"	6'-8"	1 1/2"	W.D.	P.AINT	K.P.	-	DOOR C/W HALF GLASS
D4	3'-0"	6'-8"	1 1/2"	W.D.	P.AINT	K.P.	-	SOLID DOOR
D5	6'-0"	6'-8"	1 1/2"	W.D.	P.AINT	K.P.	-	DOUBLE SLIDING GLASS DOORS
D6	5'-0"	6'-8"	1 1/2"	W.D.	P.AINT	-	-	DOUBLE SLIDING GLASS DOORS
D7	3'-0"	6'-8"	1 1/2"	H.M.L.	P.AINT	K.P.	45 MIN.	FIRE RATED H.M. DOOR & FRAME & CLOSER

- NOTES:
- GENERAL CONTRACTOR TO CONFIRM MILLWORK & FINISHES WITH THE OWNER PRIOR TO ORDERING MATERIALS.
 - ALL DIMENSIONS ARE MEASURED FROM FACE OF STUD TO STUD.

NO.	REVISION	DATE	BY
2	REVISION	10/14/2012	CS
1	ISSUED FOR BIDDING REVIEW	9/27/2012	CS

THIS DRAWING IS THE EXCLUSIVE PROPERTY OF THE CONSULTANT AND CAN BE REPRODUCED ONLY WITH THE PERMISSION OF THE ARCHITECT. THE REPRODUCTION MUST BE IN THE NAME OF THE ARCHITECT. THIS DRAWING SHALL NOT BE SCALED. FOLLOW OPEN DIMENSIONS ONLY.

THE CONSULTANT SHALL VERIFY/INSURE THAT ALL DIMENSIONS AND PERMITS TO COMMENCEMENT OF WORK REPORT ANY DISCREPANCIES TO THE ARCHITECT.

VARIOUS AND MODIFICATIONS TO WORK SHOWN WILL NOT BE ALLOWED UNLESS WRITTEN PERMISSION OF THE ARCHITECT.

CLIENT
CARTWRIGHT & DISTRICT
 EARLY LEARNING CENTRE
 BOX 190, CARTWRIGHT MB. R0K 0L0
 (T) 204-629-2307
 EMAIL: carol@cartwrightinfo.ca

ARCHITECT
OTTO CHENG ARCHITECT INC.
 ARCHITECTURE | INTERIORS
 88 CROWSON BAY, WINNIPEG, MB. R2T 0J7
 T: 204.268.3102 F: 204.453.8888
 EMAIL: sarah@ottoch.ca



PROJECT TITLE
NEW CARTWRIGHT
DAYCARE CENTRE
CARTWRIGHT, MANITOBA

SHEET TITLE
FLOOR PLAN &
FOUNDATION PLAN

DATE	BY	SCALE	SHEET NUMBER
12-025	1	AS NOTED	A-2.0